

Installation instructions for MR8 Back Door Molle Panel for Lexus GX460, GX470

It is highly recommended that you use a thread lock compound such as Loctite brand on all threads to keep them from vibrating loose. Please read these instructions entirely before starting.

This list shows the components of the MR8 kit. Parts will be referred to by the names & numbers shown here. If you are missing anything please email RefinedCycle@gmail.com.

MR8 Components....

- 1) MR8 Panel
- 2) M6-1.0x25 BHCS (qty. 9)
- 3) M6 Nuts (qty. 9)



Remove tools cover and tools panel.

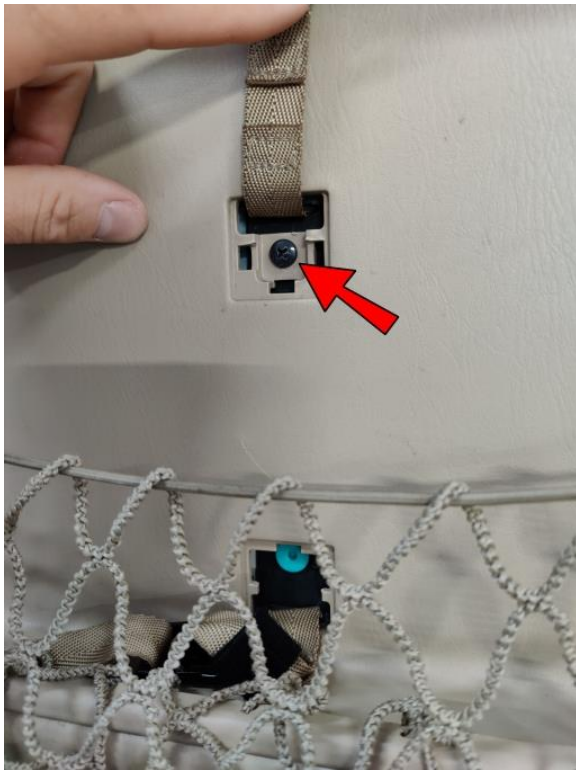

Remove this screw.



Using a plastic scraper, auto panel remover tool or (carefully) a flat blade screwdriver, lift the panel enough to be able to get your fingers underneath, then pull the lower portion of the panel away from the door to unsnap it.

Note: You only need to loosen the lower portion of the panel, not remove the entire panel.

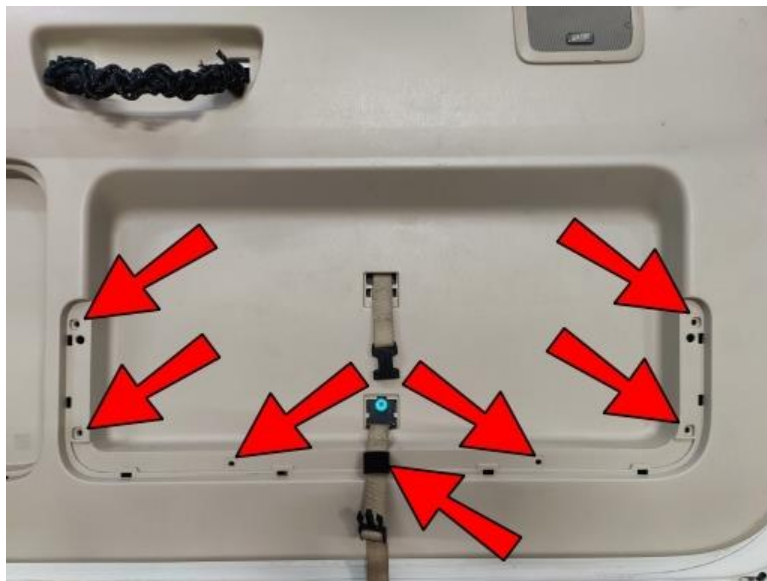

Using a stubby phillips screwdriver, unscrew the 7 screws holding the net frame, and remove it. This is well discussed online if you want to Google it.



Locate the 2 slots that are slightly larger than the others and run the strap through these. Buckle the strap and tighten, to temporarily hold the panel in place to make it easier to put the new screws in.

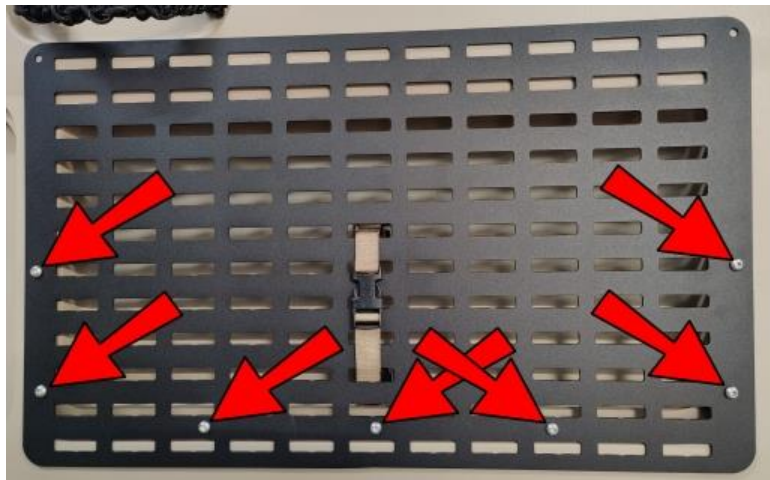

The existing holes in the plastic from the net frame are slightly smaller than the new screws. This will allow the new screws to thread into the plastic slightly. Screw 7 of the supplied screws into these holes.

Note: You will notice there are 2 additional holes at the top of the panel and 2 additional screws supplied. IF you want to, you can drill a couple holes in the plastic to secure the top of the panel but this is **OPTIONAL**. You do not need to drill any holes if you do not want to.

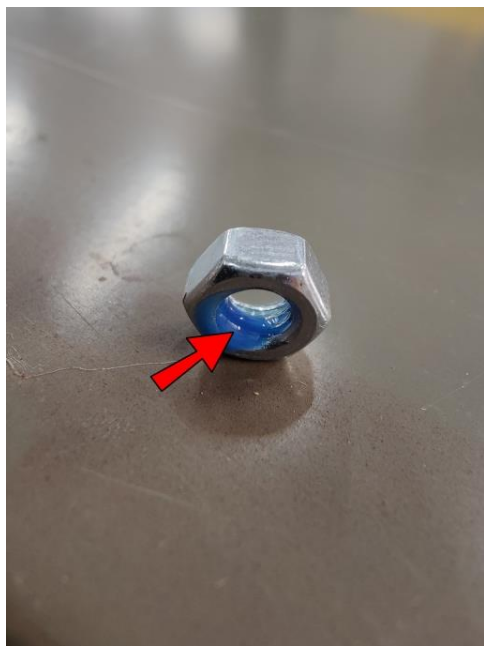

Place a little bit of threadlock into all of the nuts.



Thread the nuts onto all of the screws and tighten.



Press the door panel back against the door and make sure all of the connectors snap back into their holes.

Replace the tools and tools cover.



Undo the strap and replace the screw previously removed.



Replace the strap, tighten to further secure the panel, and tuck the end of the strap behind the panel.



Pro tip: You can buy a set of these brake picks for a couple bucks at Harbor Freight. They are VERY handy in installing Molle bags to run the straps behind the Molle panel. Once you get the end of the strap started into the slot, grab it with needle nose pliers to pull it through.



Now you can install your Molle bags and get organized! Enjoy!



For even more useful options check out our MR5 Molle Shelf!