

Installation instructions for FC11 Forward Controls for 98-03 Honda Shadow ACE 750



It is highly recommended that you use a thread lock compound such as Loctite on all threads to keep them from vibrating loose.

Please read these instructions entirely before starting.

The picture below shows the components of the FC11 kit. Parts will be referred to by the names & numbers shown here. If you are missing anything please email sales@refinedcycle.com.

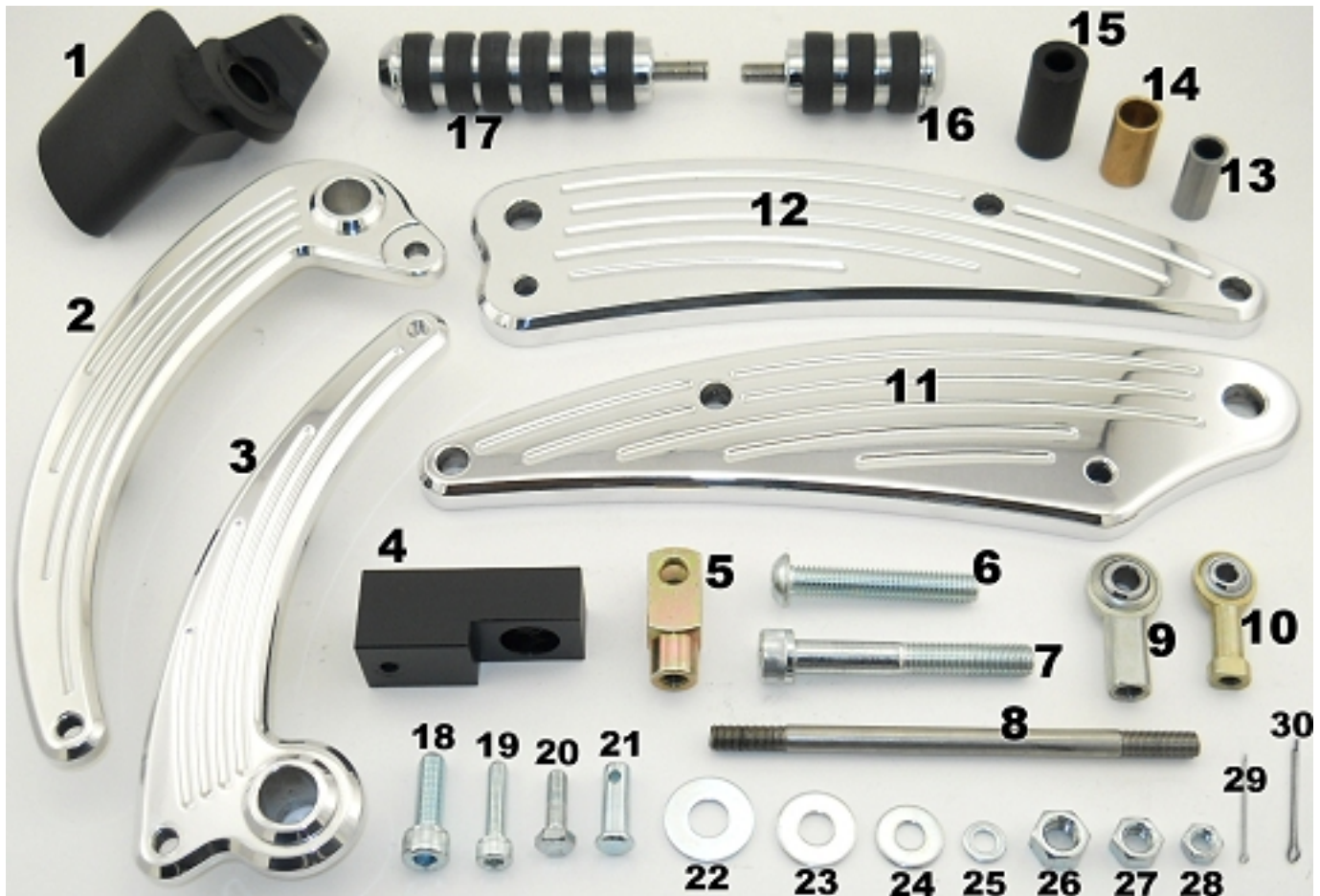

FC11 Components

- 1 - ARM11
- 2 - Brake pedal
- 3 - Shifter pedal
- 4 - ARM10
- 5 - 5/16 Clevis
- 6 - 3/8-16x2.25 button head bolt (x2)
- 7 - M10-1.25x70 socket head bolt (x4)
- 8 - Linkage (x2)
- 9 - 5/16" Spherical rod end (x3)
- 10 - M6 Spherical rod end
- 11 - FC11-R (right side)
- 12 - FC11-L (left side)
- 13 - SLV1 (x2)
- 14 - 5/8 OD x 1/2 ID Bronze OR steel sleeve (x2)
- 15 - 1.5" spacer (x4)
- 16 - Shifter peg
- 17 - Brake peg
- 18 - M8-1.25x25 socket head bolt
- 19- M6-1.0x25 socket head bolt (x3)
- 20 - M6-1.0x20 Hex bolt
- 21 - 5/16x7/8 Clevis Pin
- 22 - 3/8" Washer

- 23 - 5/16" washer (x4)
- 24 - 1/4" Washer
- 25 - M6 Washer (x2)
- 26 - 3/8-16 Nut (x2)
- 27 - 5/16-24 nut (x6)
- 28 - M6-1.0 nut
- 29 - 3/64x1 Cotter Pin
- 30 - 5/64x1 Cotter Pin



Remove the adjustment nut from the rear brake arm to release the tension on the brake system.



Remove these two bolts on both sides of the bike.



Remove the 4 header nuts and two muffer nuts and remove the exhaust system. Note: You should replace the exhaust gaskets when re-installing the exhaust.



Remove these bolts on both sides of the bike.

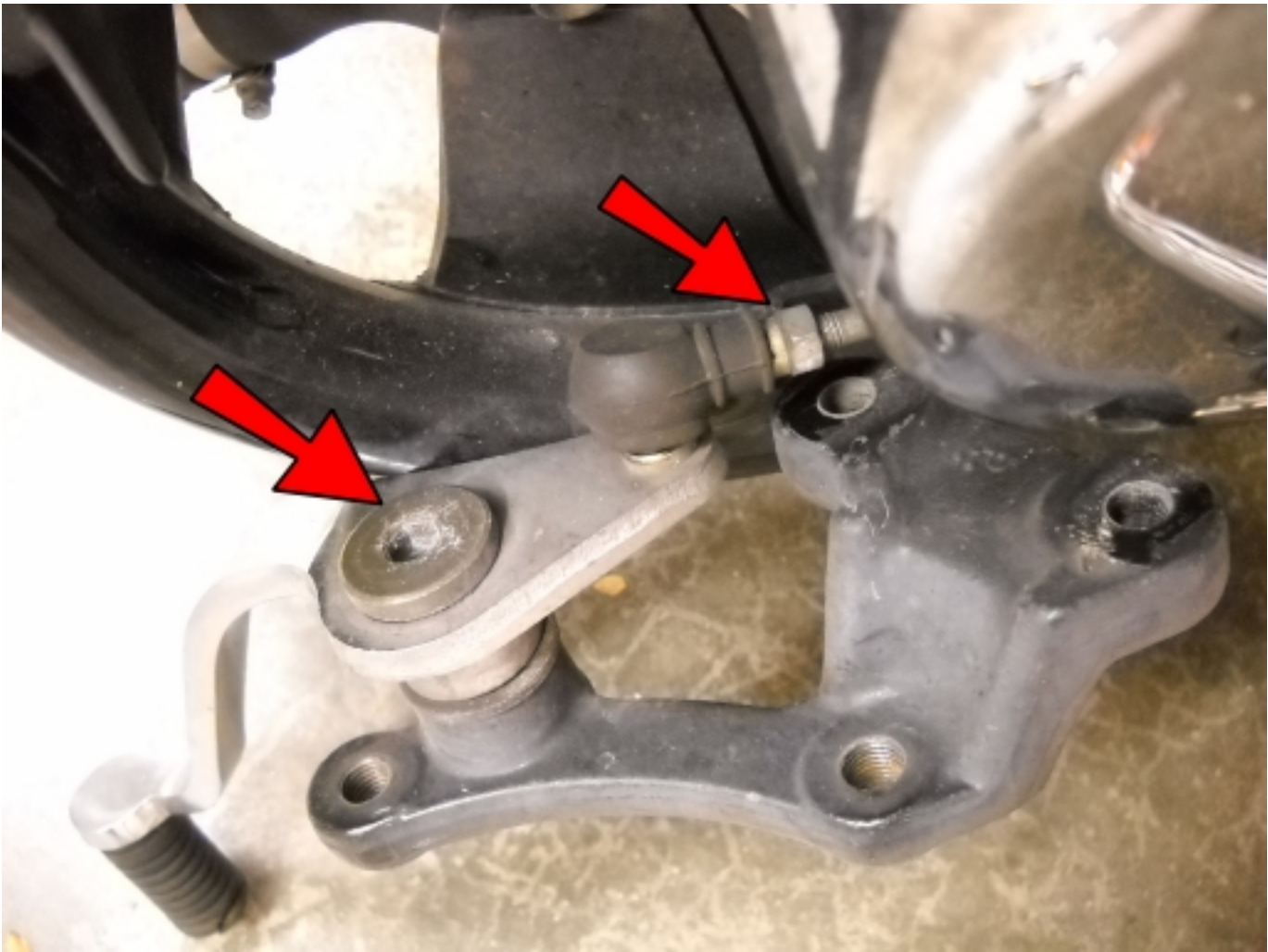

Remove the shoulder bolt that holds the shifter pedal. Loosen the nut on the shifter linkage. Hold the shifter linkage with a pair of pliers and twist the shifter pedal to unthread the ball joint from the linkage. Note: Make sure that you don't unthread the linkage from the rear end while doing this.

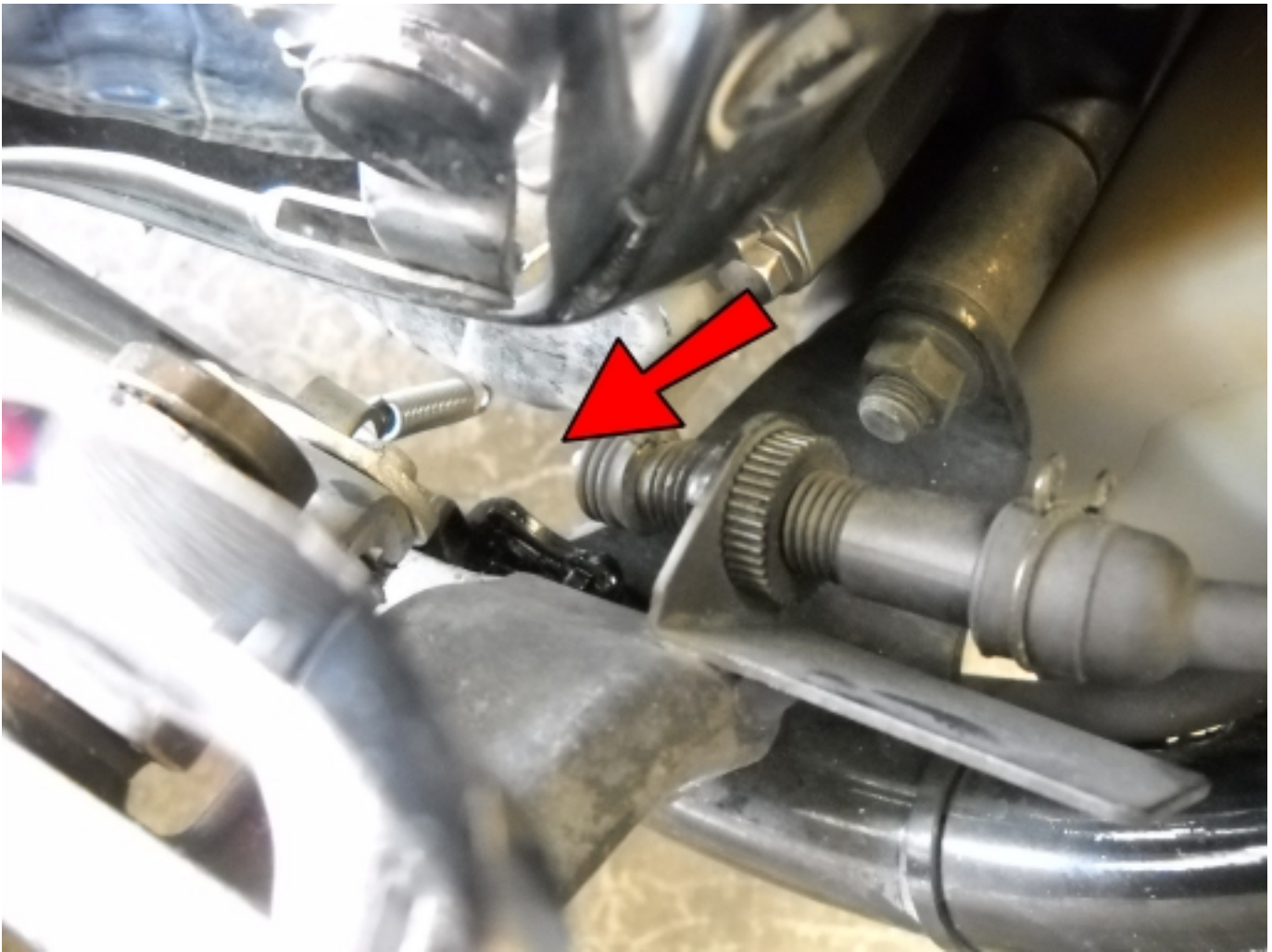

Remove the spring hook from the brake light switch.

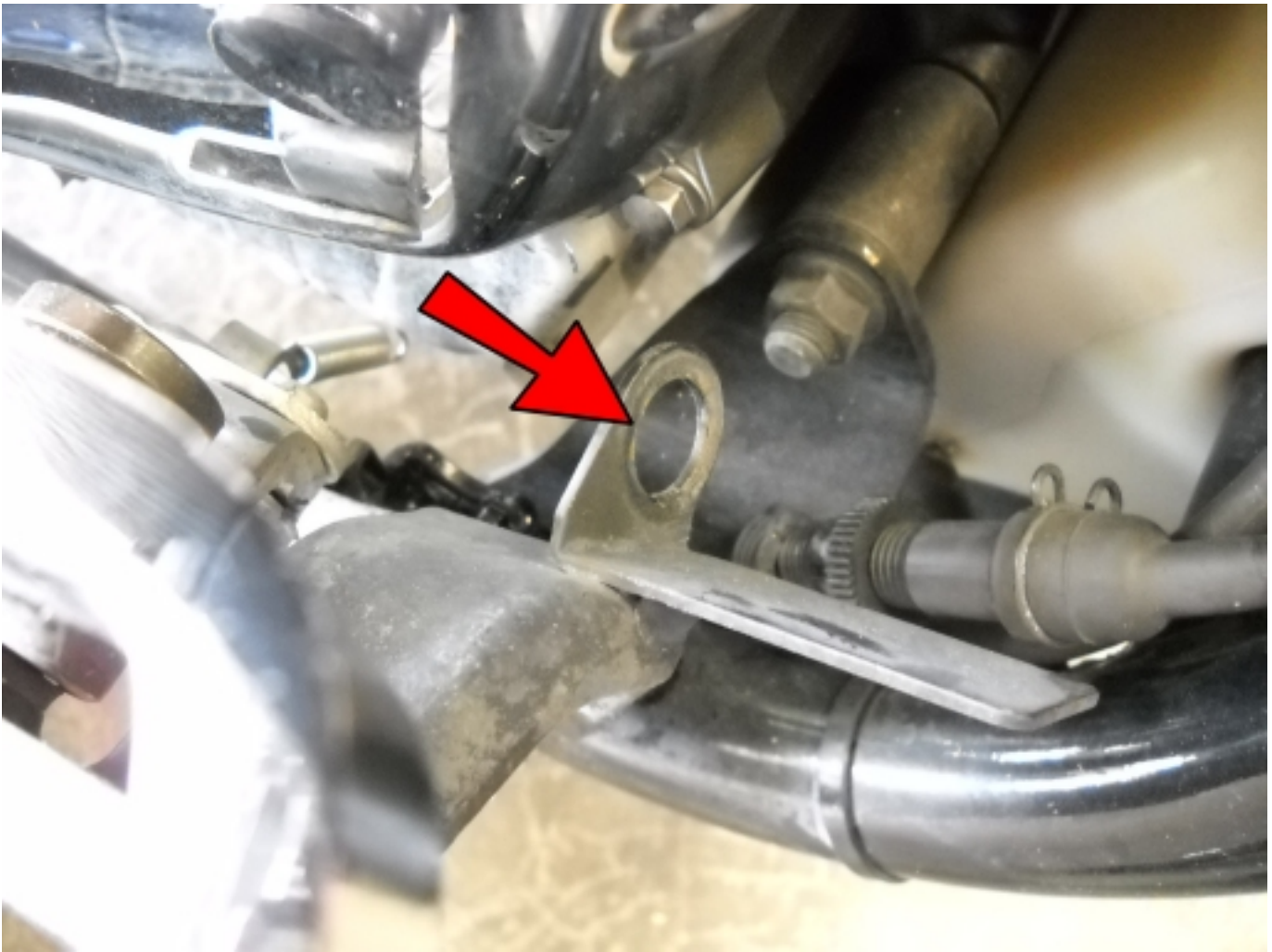

Remove the brake light switch from its mount by gently pulling up.

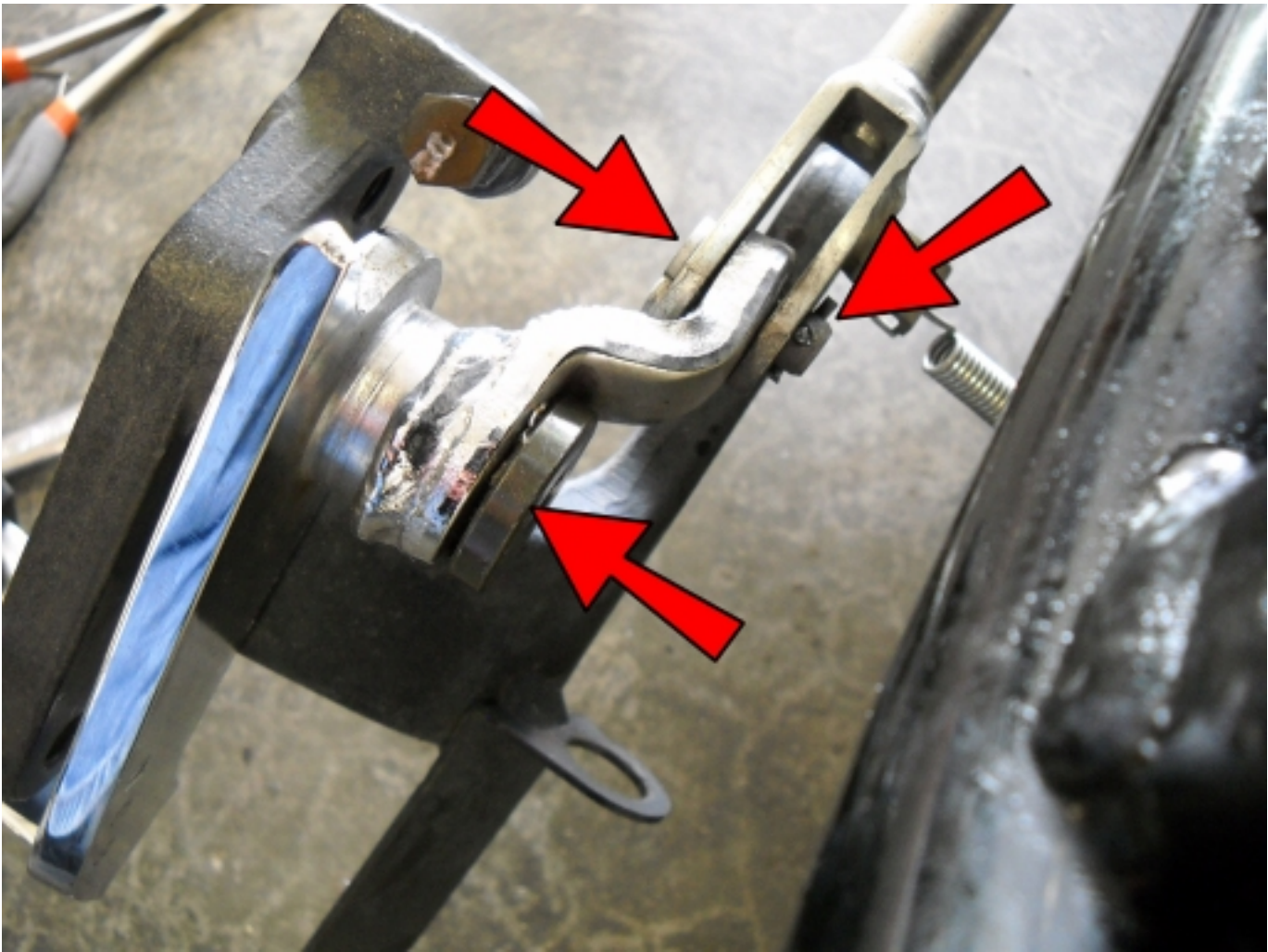

Remove the cotter pin and clevis pin to release the brake linkage, then remove the shoulder bolt that holds the brake pedal.



Apply some new grease to the shoulder bolt and use it to connect the ARM11 to the old brake pedal mount.



Put the brake light switch back into its mount.



Reconnect the spring to the brake light switch.

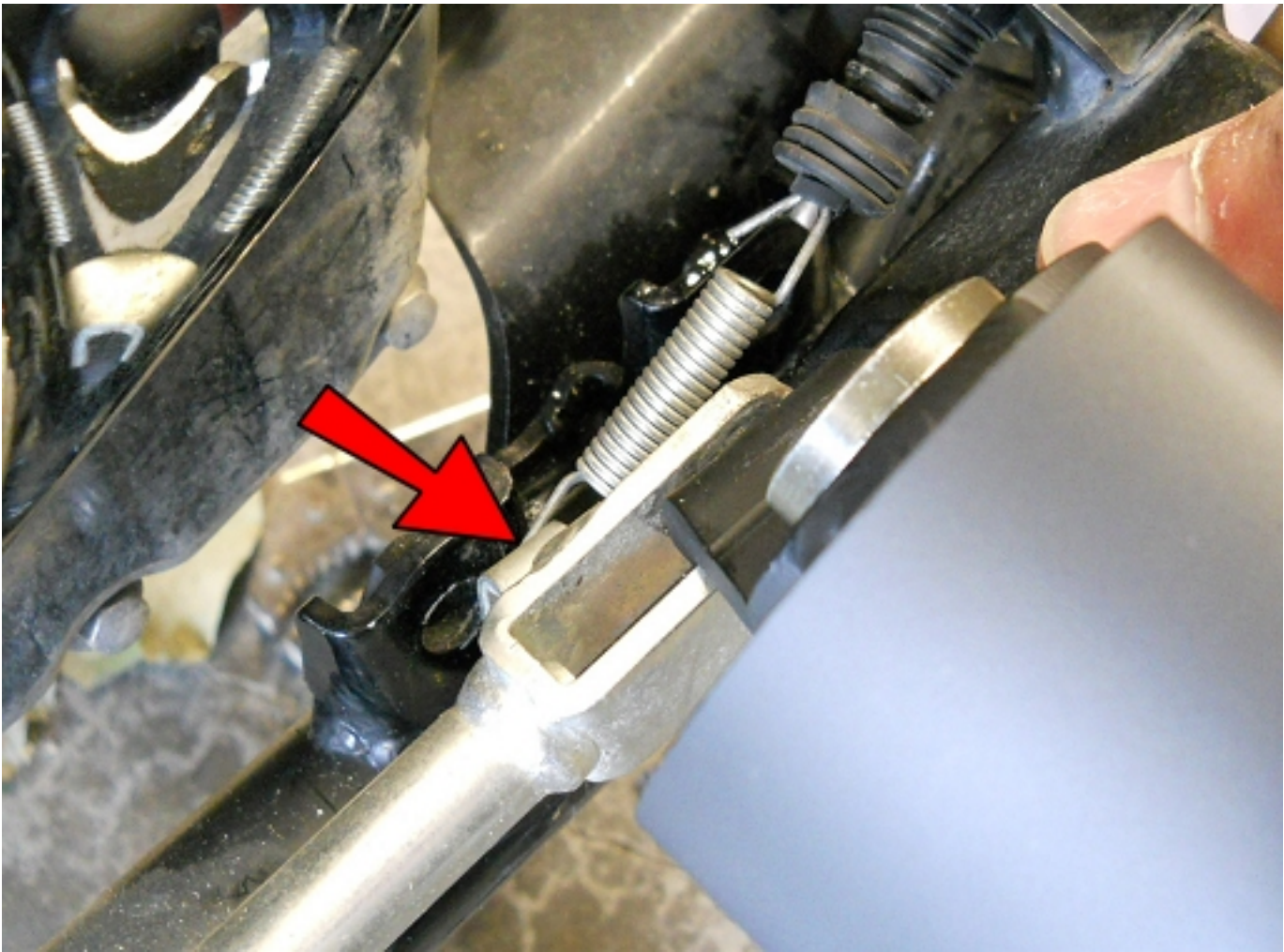

Reconnect the spring to the brake linkage if you removed it or it fell out.

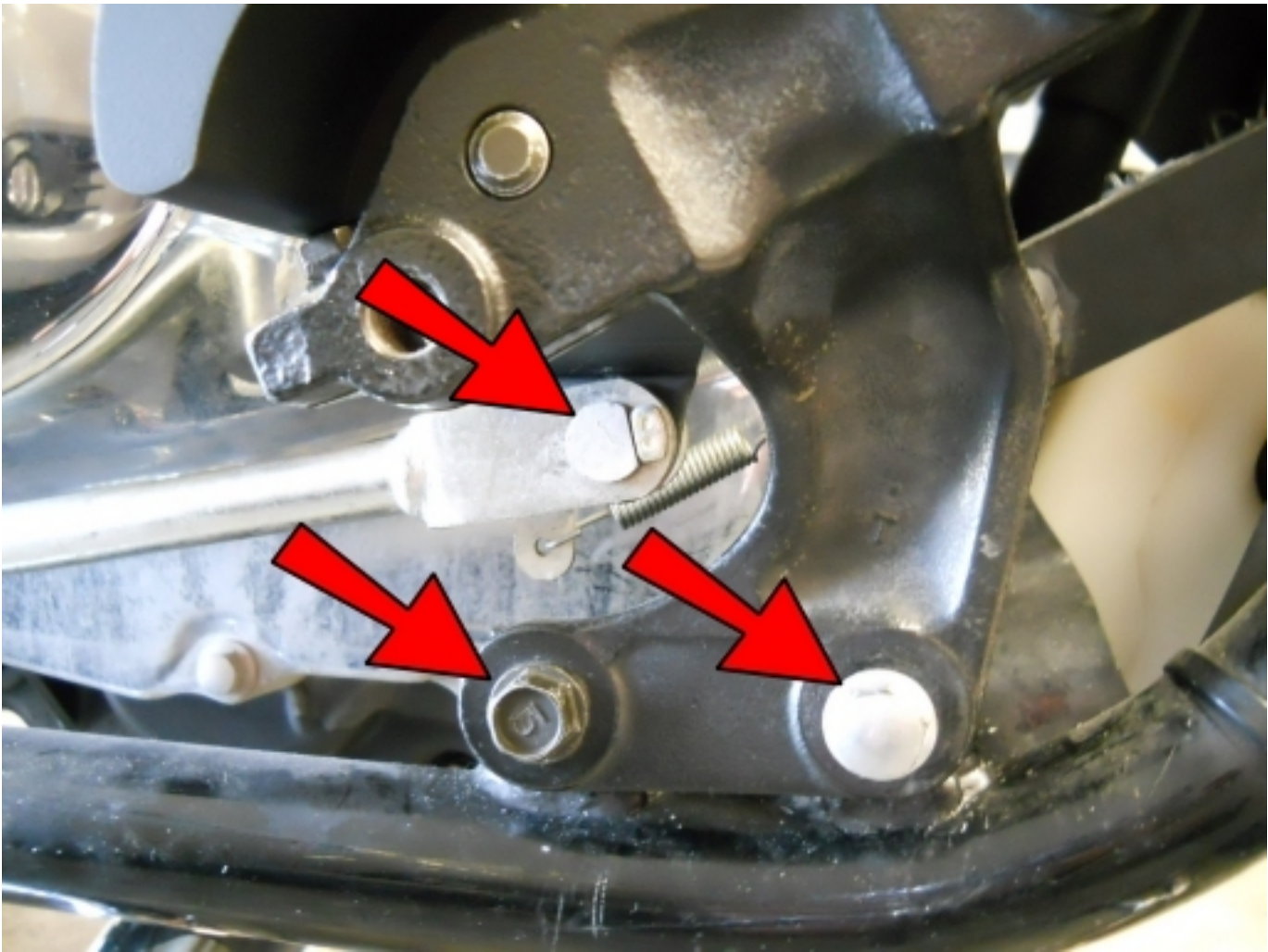

Connect the brake linkage to the ARM11 with the old clevis pin and the supplied 3/64x1 Cotter Pin.

Connect the mount back to the frame. Then re-install the exhaust system. Note: It is recommended that you use new exhaust gaskets any time you remove and re-install the exhaust system.

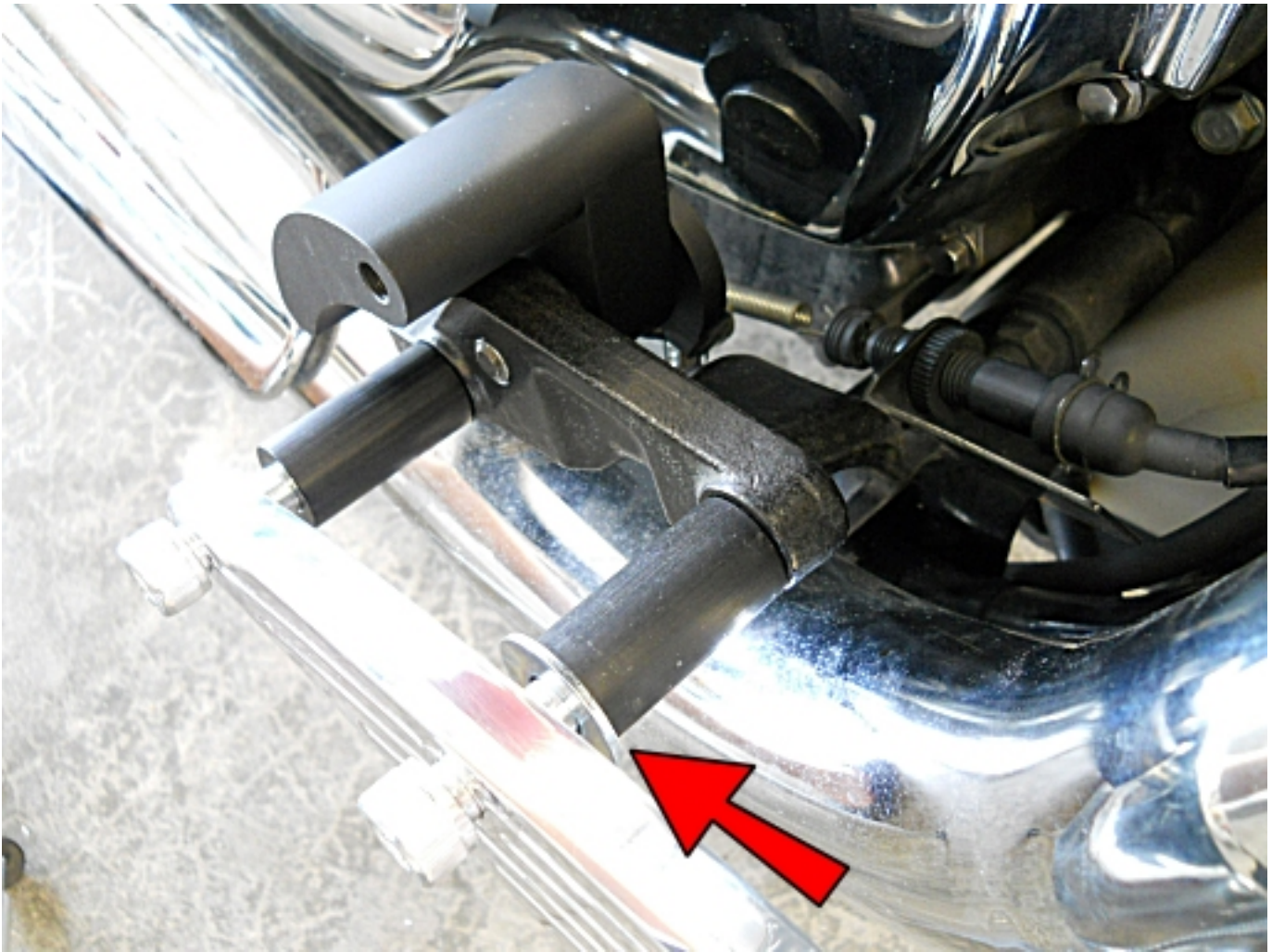

Attach the FC11-R to the old foot peg mount with the supplied M10-1.25x70 bolts, 1.5" Spacers and ONE, 3/8 Washer, on the front, as shown. Note: Depending on which exhaust system you have, you can use more, or NO washers, to adjust for clearance of the brake linkage.



Thread a 3/8-16x2.25 bolt into the bottom hole as shown.



Apply grease to the outside surface of both SLV1's and the inside and outside of both the 5/8x1/2 Bronze Sleeves.

Place a SLV1 into a 5/8x1/2 Bronze Sleeve and insert them into the Brake Pedal. Also do this on the Shifter pedal and set it aside.

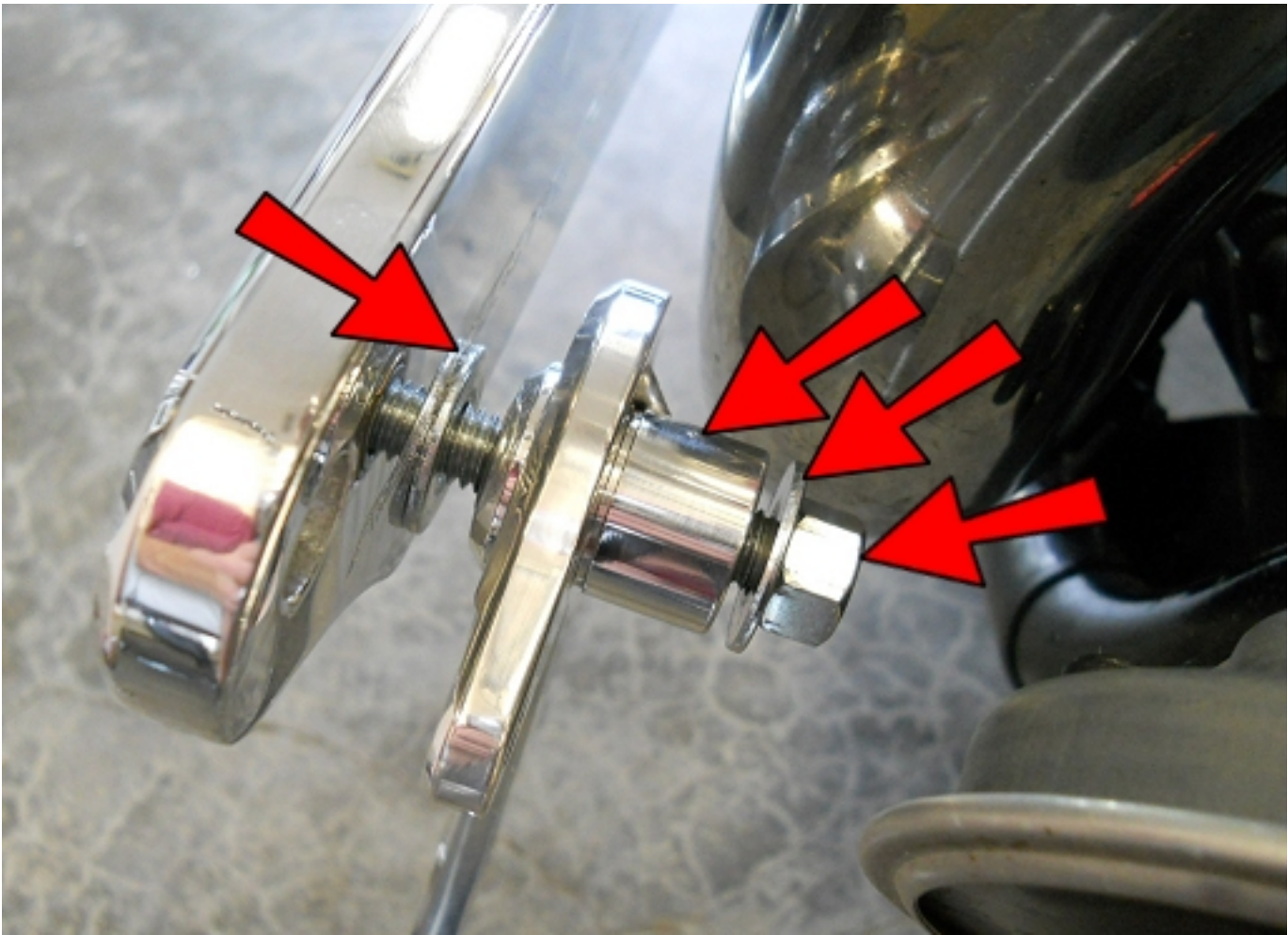

Slide a 5/16 Washer onto the 3/8-16x2.25 bolt that you just installed. Place the Brake pedal assembly on next, then another 5/16 Washer and secure with a 3/8 Nut.



Assemble the Brake Linkage as shown, using a 5/16 Spherical Rod End, a 5/16 Clevis and two 5/16-24 Nuts.



Attach the Brake Linkage to the Brake Pedal with a 5/16 Clevis, 1/4 Washer and 5/64x1 Cotter Pin as shown.

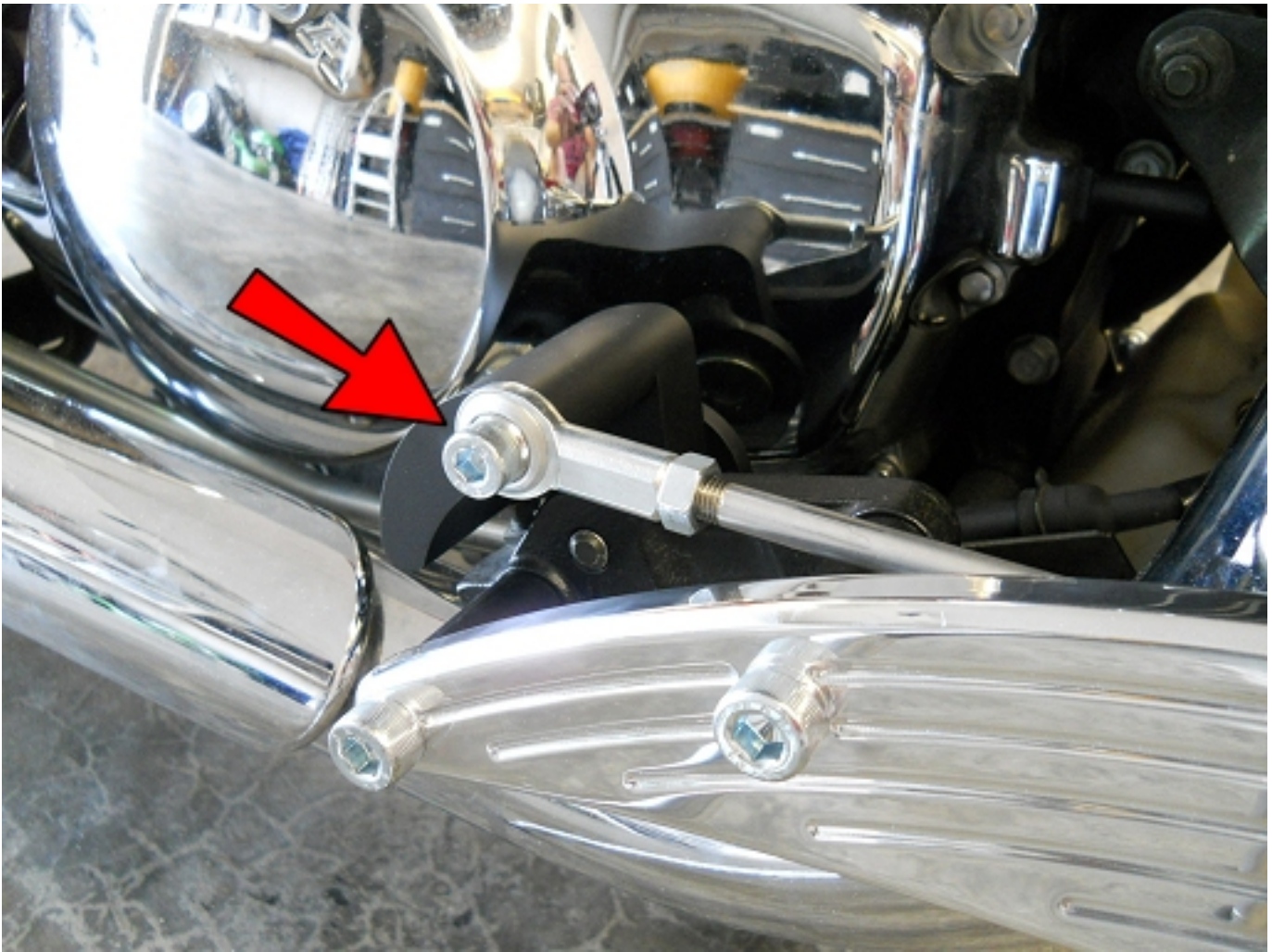

Rotate the linkage around and connect it to the Arm11 with an M8-1.25x25 bolt.

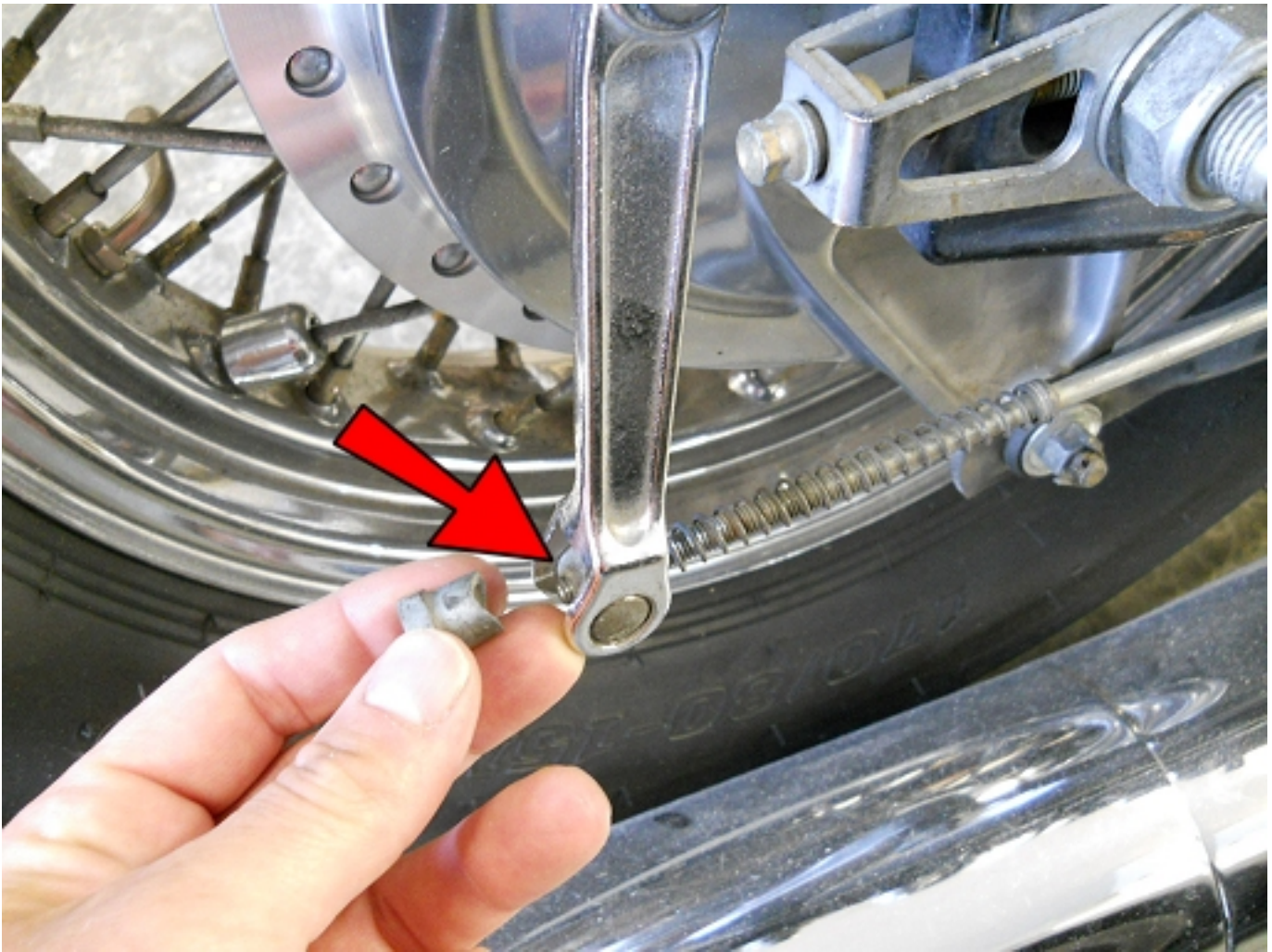

Replace the adjustment nut on the rear brake arm. Push the brake arm all the way forward as you thread the nut on to make it easier to turn. You want very little play in the brake arm, so that when you push the brake pedal, it doesn't have to move far to apply the brakes. However, do not make it SO tight, that the wheel can't turn freely.



The Brake Pedal height can be raised or lowered by removing one end of the linkage and threading the Linkage Rod into or out of both ends a little. Retighten the 5/16 Nuts when you are finished.

The brake light switch may need to be adjusted. To test it, turn your key on and observe your brake light while pressing and releasing the brake pedal a few times. If the brake light works as desired, no adjustment is necessary. If it stays on all the time, thread the adjustment wheel on the brake light switch farther on, to loosen the spring tension. Hold the brake light switch while adjusting it, to keep it from turning with the adjustment wheel. If it does not come on at all, tighten the tension on the brake light switch. With a little trial and error you will find the right position.

This completes the brake side.



On the shifter side, thread an M6 Spherical Rod End onto the old shifter linkage and place an M6-1.0x20 bolt into the end as shown.

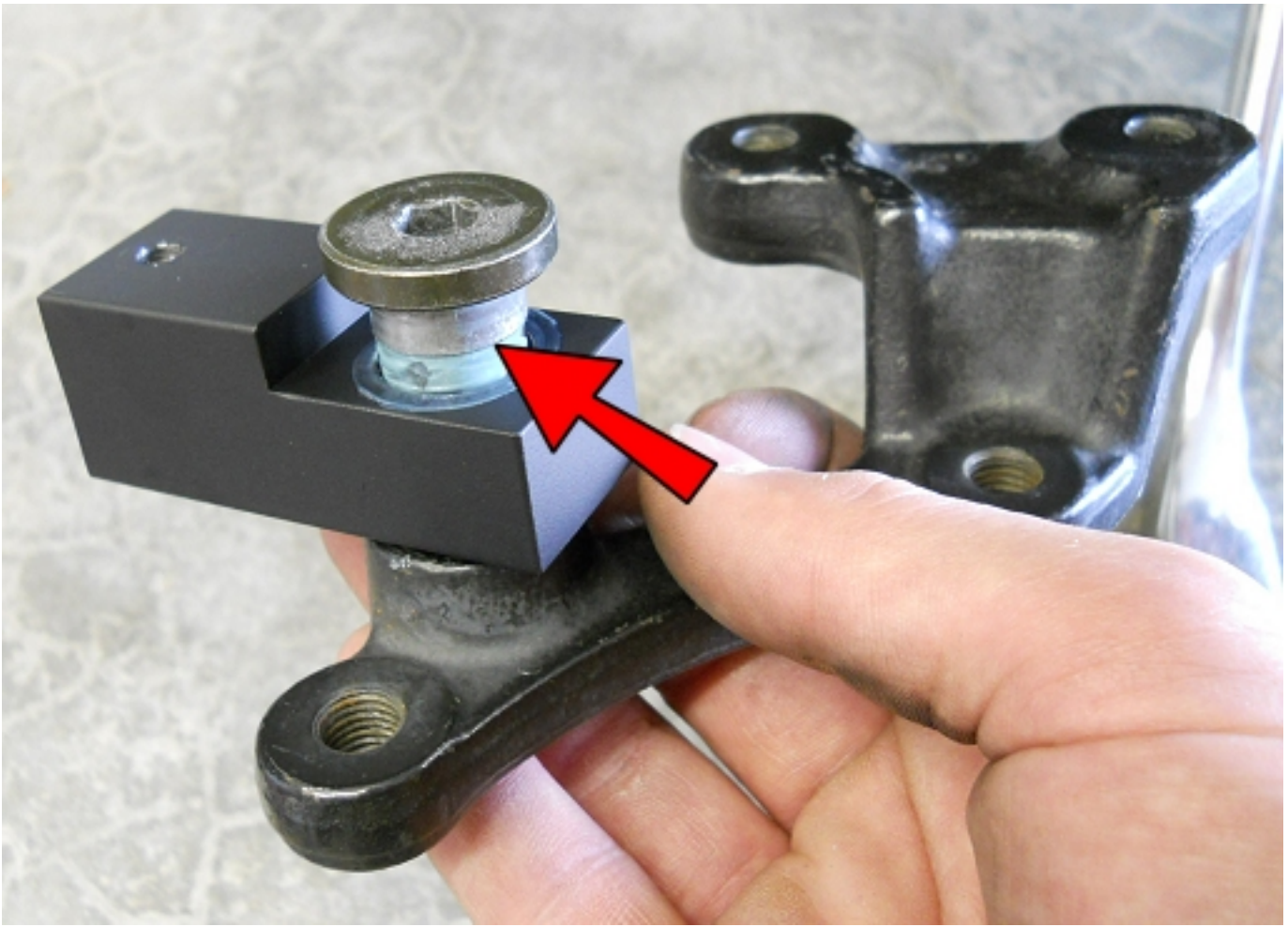

Apply some new grease to the shoulder bolt and use it to connect the ARM10 to the old shifter pedal location.

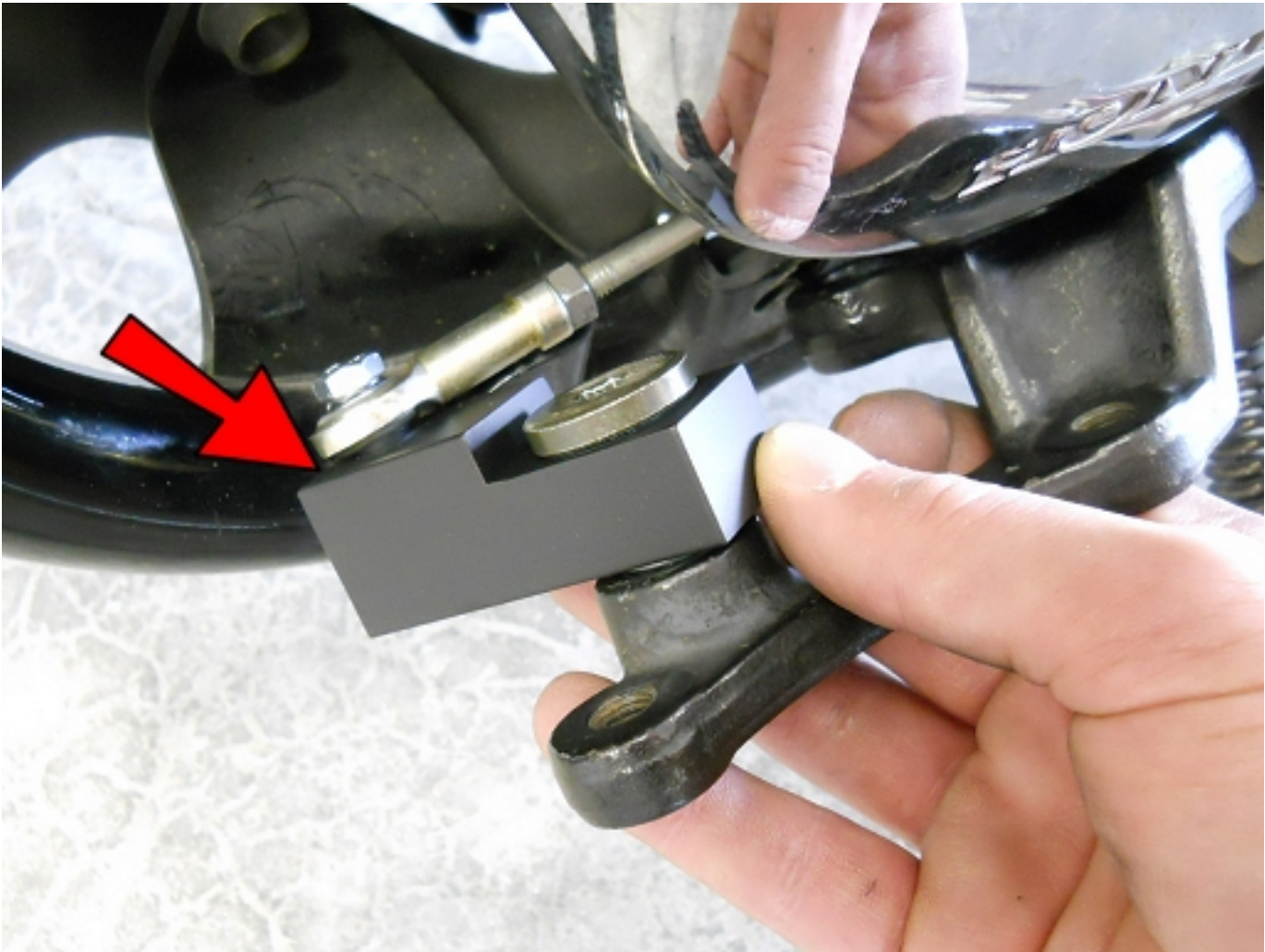

Connect the ARM10 to the shifter linkage as shown.

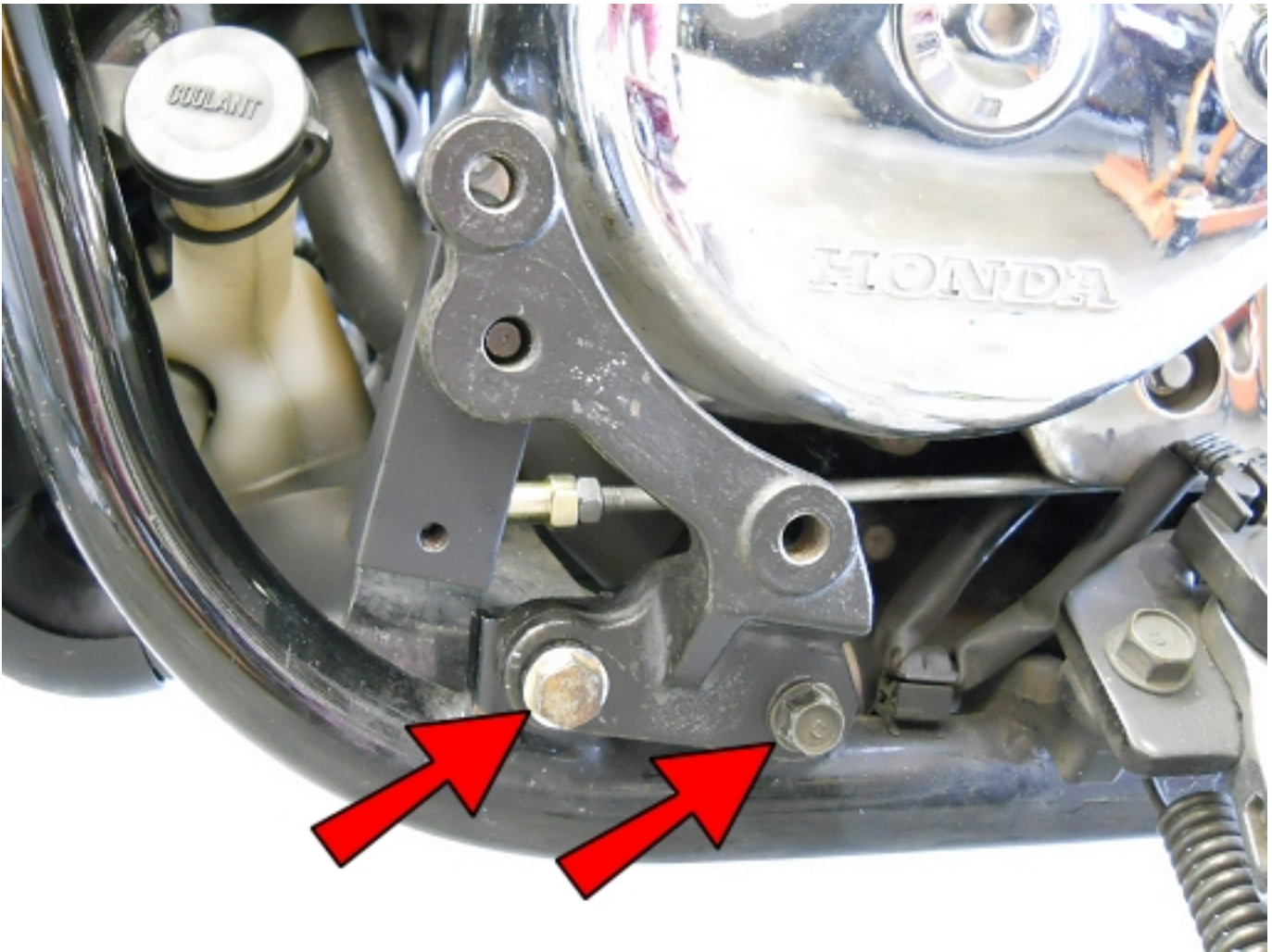

Connect the old mount back to the frame as shown. Then attach the FC11-L to the old foot peg mount with the supplied M10-1.25x70 bolts and 1.5" Spacers, as done on the other side, EXCEPT you will not use a 3/8 Washer on this side.



Assemble the Shift Linkage as shown, using two 5/16 Spherical Rod Ends and two 5/16-24 Nuts.

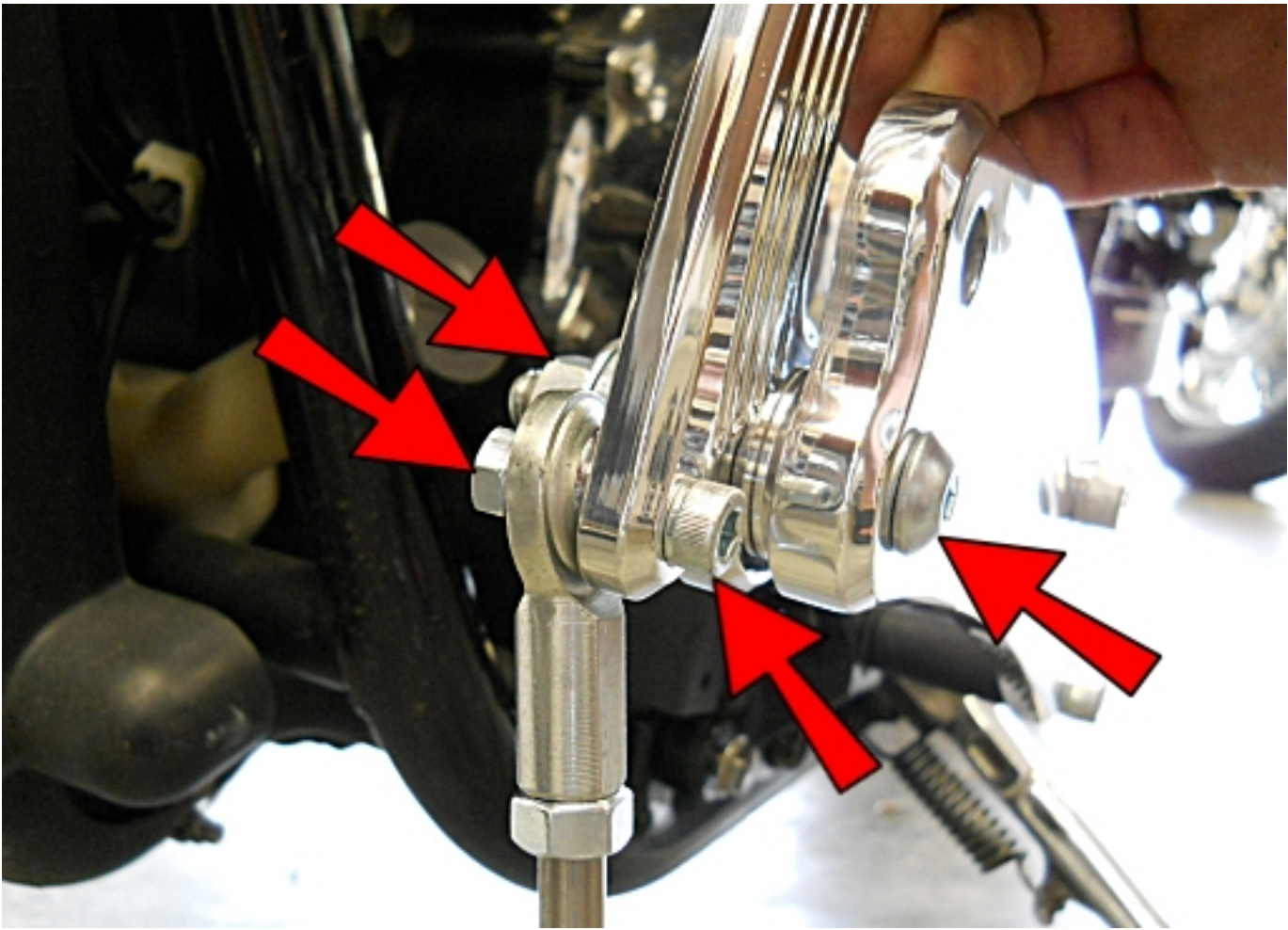

Thread a 3/8-16x2.25 bolt into the bottom hole as was done on the other side.

Slide a 5/16 Washer onto the 3/8-16x2.25 bolt that you just installed. Place the Shifter pedal assembly (with the sleeves you greased and inserted earlier) on next, then another 5/16 Washer and secure with a 3/8 Nut.

Connect the Shifter Linkage to the Shifter Pedal with an M6-1.0x25 bolt and secure with an M6 Nut as shown.

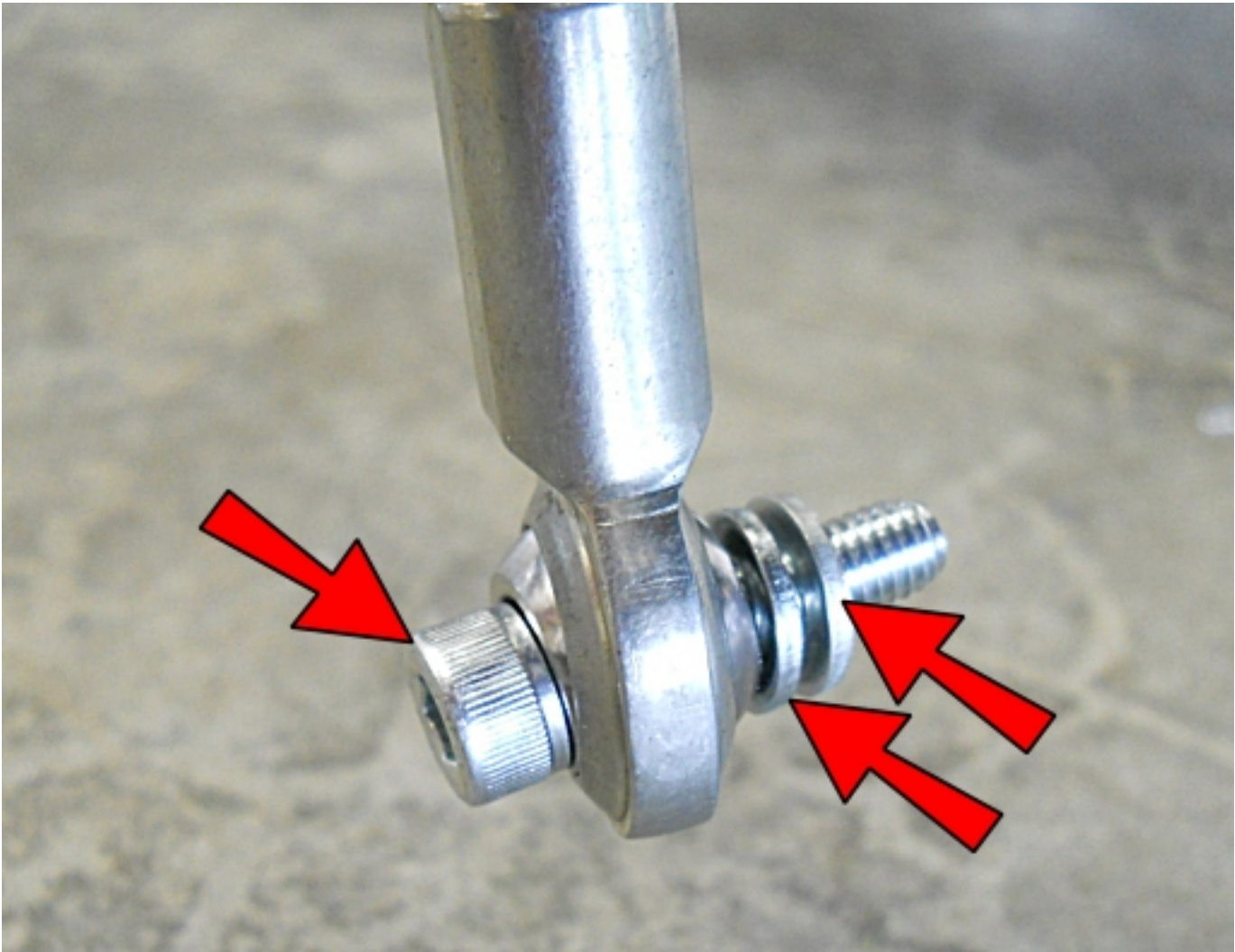

Place another M6-1.0x25 bolt into the other end of the Shifter Linkage, then place TWO M6 Washers onto the bolt as shown.



Now secure that linkage end to the ARM10 as shown.

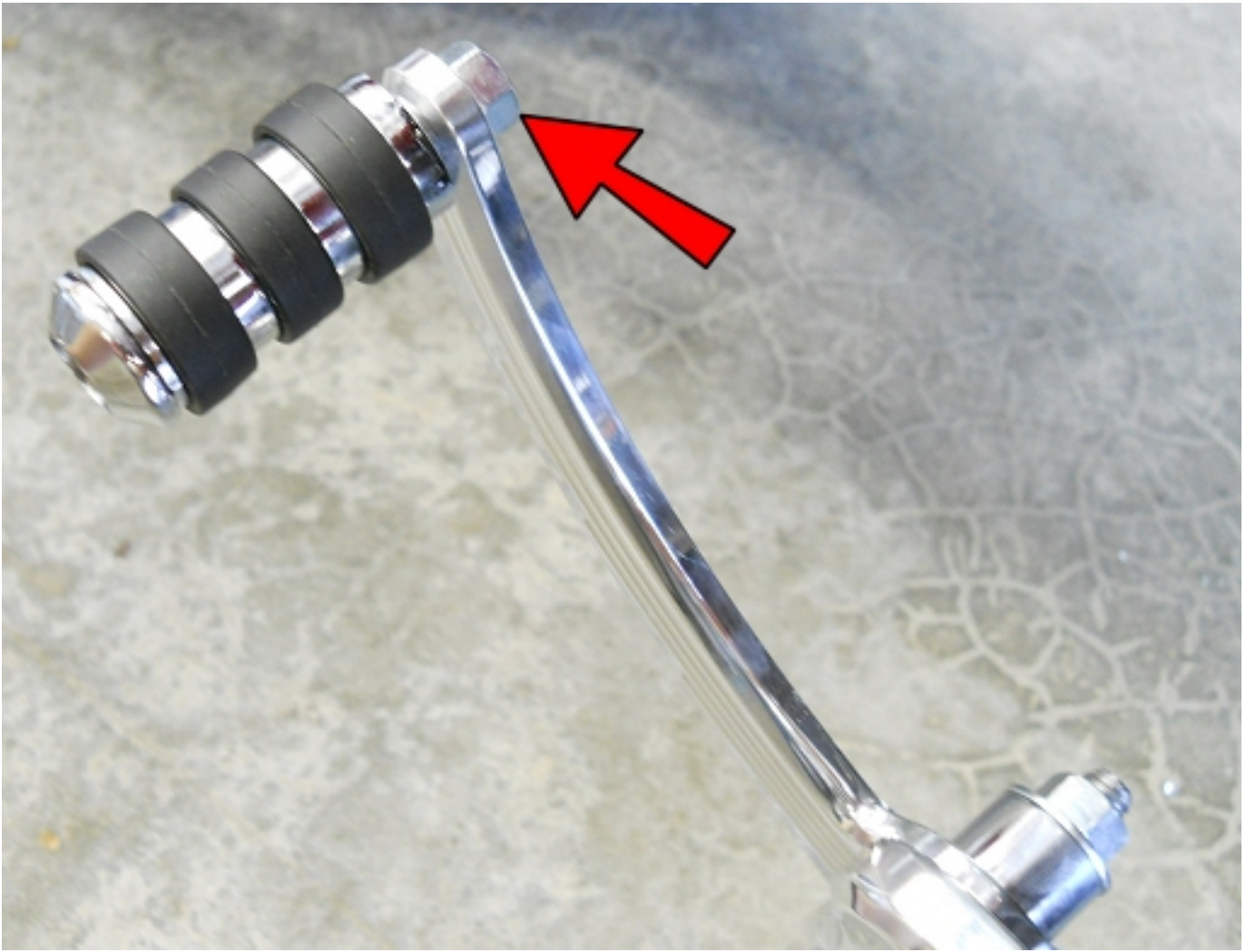

Connect the Shifter Pedal Toe Peg and secure with a 5/16 Nut as shown.



Install the foot peg.

The Shifter Pedal height can be adjusted in the same manner as the Brake side.

That's it! It is recommended that at this point you double check that ALL connections are tight and take the bike for a test ride and make any other adjustments necessary for the optimal position of your shifter and brake pedals.

Enjoy the ride!